

DAV-MS Combination and Kinetic Valves

Dimensions & Weights

Nom. diameter		Height H		Width W		d-Kinetic orifice area		Approx. shipping Weight	
inch	mm	inch	mm	inch	mm	inch ²	mm ²	kg	lbs
3	80	10.9	277	9.2	235	3.0	1960	12	26.4
4	100	14	356	12.8	326	7.8	5025	22	48.4
6	150	15.5	395	15.5	395	12.2	7855	36	79
8	200	17.8	452	24.4	621	27.4	17670	59	130
10	250	22	558	19.8	503	48.7	31415	100	220.5
12	300	30.5	775	27.8	707.5	76.1	49090	210	463

Connections: ISO, ANSI, BS, JIS flanges, BSP, NPT threads (50mm valves only)

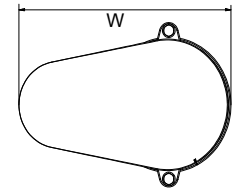
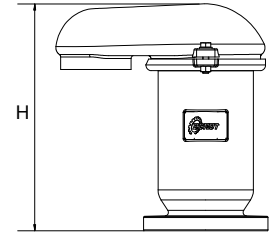

Specifications

Nominal sizes	3" / 80mm to 12" / 300mm
Pressure rating	PN16 (250 psi), PN25 (350 psi) and PN40 (580 psi)
Minimal pressure for drip-tight sealing	0.1 bar *
Temp. Range	Operating: 0-60°C / 32-140°F
	Storage: -10-70°C / 15-160°F

* For size 2" - please consult with Dorot engineers

Aero-Dynamic Performance

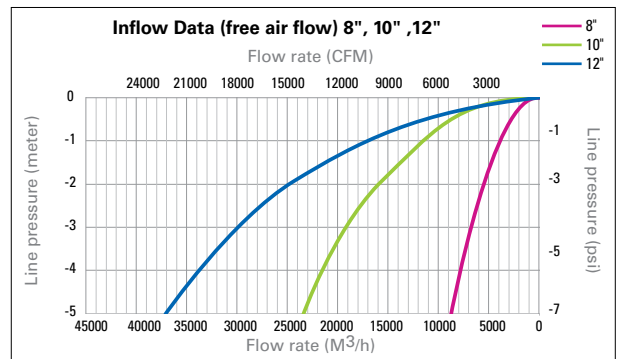
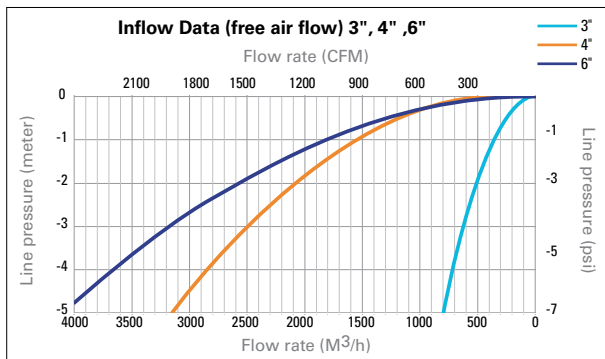
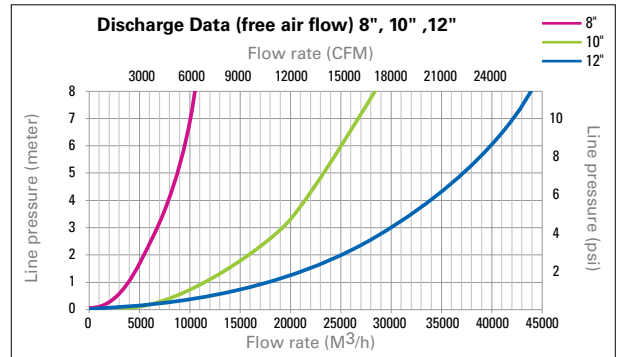
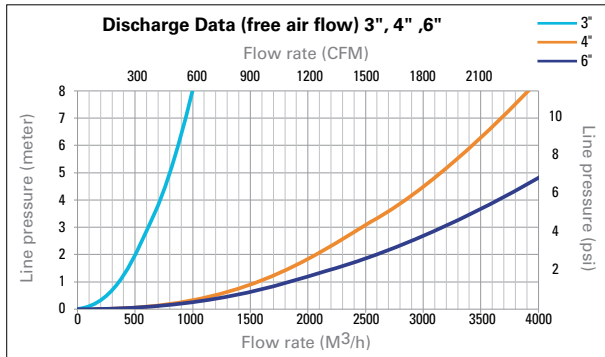

Small-orifice ('Automatic') discharge flow

