

## Dimensions of Series DBV-WF/LU Valves

Valve Size		A		B		C		D		E		F		G		n x ØH		d		L		M	
inch	mm	inch	mm	inch	mm	inch	mm	inch	mm	inch	mm	inch	mm	inch	mm	inch	mm	inch	mm	inch	mm	inch	mm
2	50	2	52.6	5.6	142	1.3	32	3.1	80	3.8	96	2.8	70	3.5	90	4x0.4	10	0.5	12.7	1.7	43	0.5	11
2.5	65	2.5	64.4	6.1	155	1.3	32	3.5	89	4.6	116	2.8	70	3.5	90	4x0.4	10	0.5	12.7	1.8	46	0.5	11
3	80	3	78.9	6.3	161	1.3	32	3.7	95	5.2	132	2.8	70	3.5	90	4x0.4	10	0.5	12.7	1.8	46	0.5	11
4	100	4.1	104.1	7.1	180	1.3	32	4.5	114	6	152	2.8	70	3.5	90	4x0.4	10	0.6	15.9	2	52	0.5	11
5	125	4.9	123.4	7.6	193	1.3	32	5	127	7.2	182	2.8	70	3.5	90	4x0.4	10	0.8	19.1	2.2	56	0.6	14
6	150	6.1	156	8.1	205	1.3	32	5.5	139	8.1	205	2.8	70	3.5	90	4x0.4	10	0.8	19.1	2.2	56	0.6	14
8	200	8	202.9	9.8	250	1.6	40	6.9	175	10.2	260	4	102	4.9	125	4x0.5	12	0.9	22.2	2.4	60	0.7	17
10	250	9.9	250.9	11.1	282	1.6	40	8	203	12.4	315	4	102	4.9	125	4x0.5	12	1.1	28.6	2.7	68	0.9	22
12	300	11.9	301.9	12.8	326	1.6	40	9.5	242	14.6	371	4	102	4.9	125	4x0.5	12	1.3	31.8	3.1	78	0.9	22
14	350	13.1	334	14.1	358	1.6	40	10.5	267	16.6	421	4	102	4.9	125	4x0.5	12	1.3	31.8	3.1	78	0.9	22
16	400	15.4	390	15	380	2.1	52	11.6	301	18.6	471	5.5	140	6.9	175	4x0.7	18	1.5	38.1	4/3.5	102/88	0.9	22
18	450	17.4	441	16	422	2.1	52	15	381	20.7	526	5.5	140	6.9	175	4x0.7	18	1.6	41.3	4.5/4.2	114/	1.1	27
20	500	19.4	492.3	18.9	479	2.5	64	15.2	387	22.6	575	5.5	140	6.9	175	4x0.7	18	1.8	44.5	5	127	1.1	27
24	600	23.4	593	22.1	562	2.8	70	18	457	27	686	6.5	165	8.3	210	4x0.9	23	2	50.8	6.1	154	1.4	36

## Weights

Valve Size		Series WF Gear		Series LU Gear		Series WF Lever		Series LU Lever	
inch	mm	lb	kg	lb	kg	lb	kg	lb	kg
2	50	6.6	3	9.9	4.5	3.5	1.6	6.8	3.1
2.5	65	7.5	3.4	11.9	5.4	4.4	2	8.8	4
3	80	8.4	3.8	11.7	5.3	5.3	2.4	9.7	4.4
4	100	9.7	4.4	17.4	7.9	6.6	3	14.3	6.5
5	125	13	6	27	12	10	4.6	24	10.6
6	150	14	6.5	28	12.5	11	5	24	11
8	200	40	18	57	26	35	16	53	24
10	250	66	30	104	47	62	28	99	45
12	300	84	38	130	59	71	32	117	53
14	350	121	55	163	74	79	36	121	55
16	400	135	61	203	92				
18	450	174	79	231	105				
20	500	282	128	381	173				
24	600	414	188	529	240				

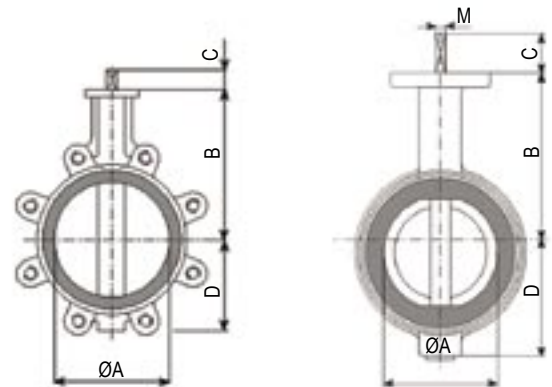
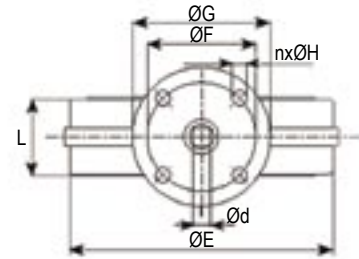

## Components

No.	Qty	Description
①	1	Thrust Washer
②	1	Retaining Ring
③	2	O-Ring
④	3	Bearings
⑤	1	O-Ring
⑥	1	Disc
⑦	1	Stem
⑧	1	Seal
⑨	1	Body

## Material selection

### BODY

- **D** - Ductile iron ASTM A536 (standard)

### SEAL

- **E** - EPDM (standard)
- **N** - Buna-N

### STEM

- **S4** - 410SS ASTM A582 Type 410 (standard)
- **S3** - 316SS ASTM A276 Type 316

### DISC

- **DI** - Electro-feritic Coated Ductile Iron ASTM A536 (standard)
- **AL** - Aluminum Bronze ASTM B148-954
- **SS** - 316 SS ASTM A351 CF8M

## Operating Temperature Range of Seals

Type	Minimum	Maximum
EPDM	-40°F (-40°C)	+250°F (121°C)
BUNA-N	0°F (-18°C)	+212°F (100°C)

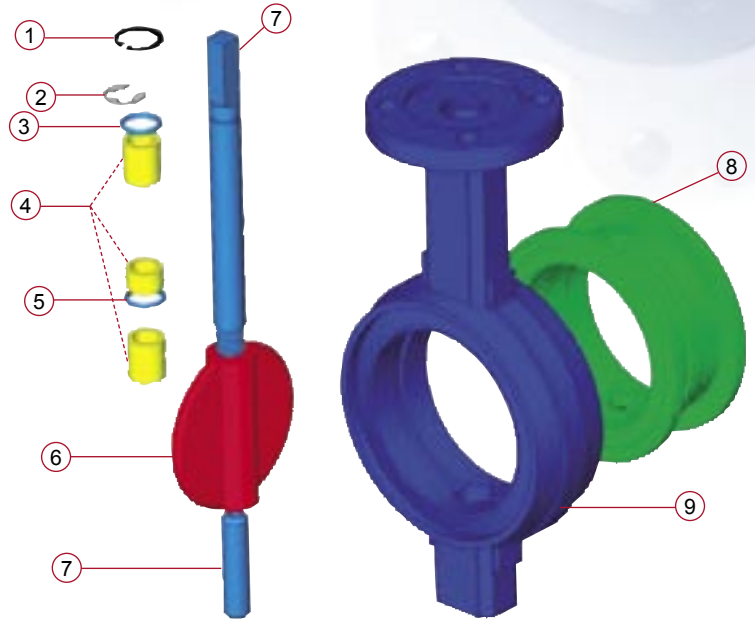

## Valve Actuators

- ① **G** - Gear actuator
- ② **H** - Hand Lever
- ③ **P** - Pneumatic actuators

